

1 2 3 4 5 6 7 8

A

B

C

D

E

F

G

H

Material:  
 Housing: PBT+Glass Filled Polyester  
 Flammability Rating : UL94V-0  
 Contacts: Phosphor Bronze  $\phi 0.46\text{mm}$   
 Plating: Gold Plating  
 Shield: Brass, Tin Plating

Electrical:  
 Voltage Rating: 125VAC  
 Current Rating: 1.5A  
 Contact Resistance:  $30\text{m}\Omega$  Max.  
 Insulation Resistance:  $500\text{M}\Omega$  Min.  
 Dielectric Strength: 1000VAC Rms  
 50Hz, 1 Min.  
 Durability: 600 cycles Min.  
 Operation Temperature:  $-40^{\circ}\text{C} \sim +70^{\circ}\text{C}$

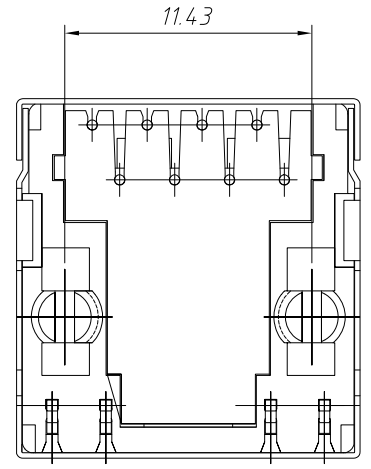
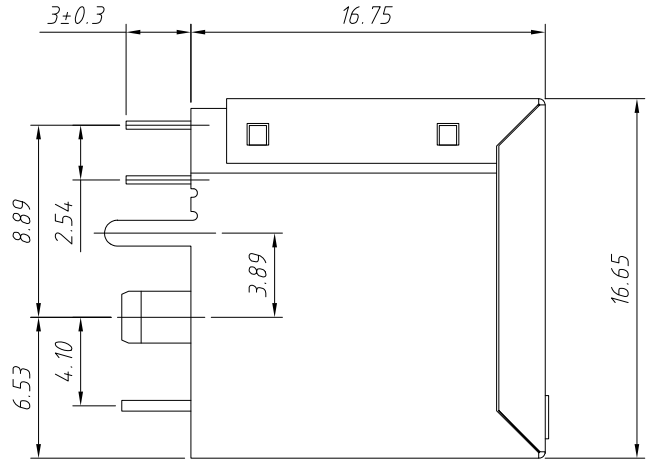
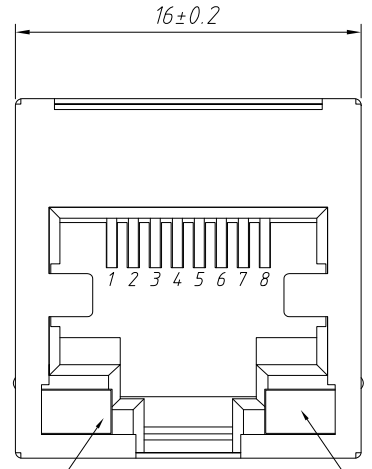

LED RIGHT LED LEFT

Order Information

L-KLS12-109B-8P8C-W- G/Y-XX

RoHS  
 Contacts: 8P8C  
 Shield: W-with Shield  
 LED Code: LEFT/RIGHT  
 G/Y-Green/Yellow  
 Y/G-Yellow/Green  
 Plating Code:  
 01-1u" Gold Plating  
 02-3u" Gold Plating  
 03-6u" Gold Plating  
 04-15u" Gold Plating  
 05-30u" Gold Plating

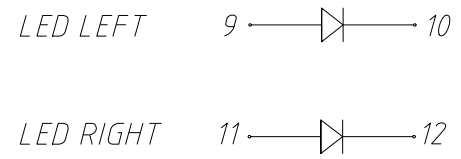
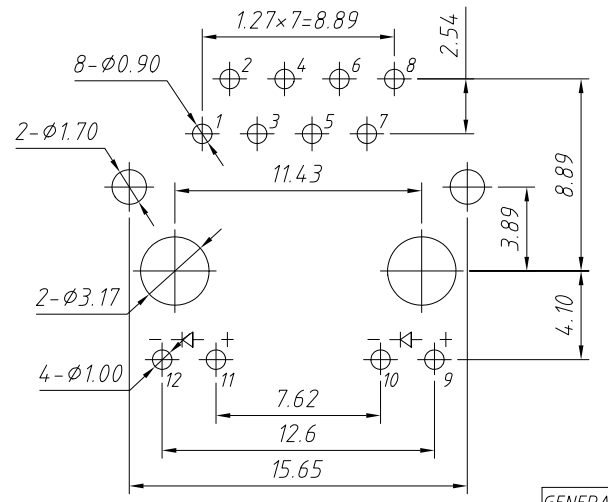

PCB Layout

GENERAL TOLERANCE	PROJECTION		Description:
X. $\pm 0.30$	UNITS	mm	Modular jacks with LED, RJ45-8P8C with SHELL
.X $\pm 0.25$	SCALE	1:1	
.XX $\pm 0.20$	Draw by:	Jenny	KLS P/N: L-KLS12-109B-8P8C-W-G/Y-01
ANGLE TOLERANCE	Check by:	Daniel	NingBo KLS ELECTRONIC CO.,LTD.
X. $\pm 3^{\circ}$	Date	2019-12-26	
.X $\pm 2^{\circ}$	SHEET	1 OF 1	
.XX $\pm 1^{\circ}$			

1 2 3 4 5 6 7 8