

# KBU 4 / 6 / 8

## BRIDGE RECTIFIERS

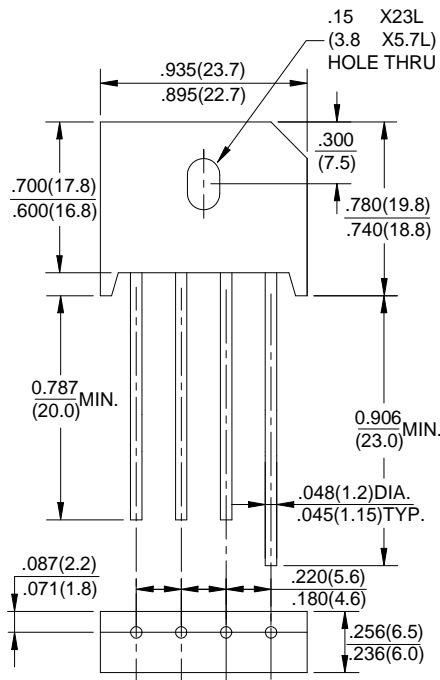

Dimensions in inches and (millimeters)

### GLASS PASSIVATED BRIDGE RECTIFIERS

REVERSE VOLTAGE - 50 to 1000Volts

FORWARD CURRENT - 4 / 6 / 8 Amperes

### FEATURES

- Surge overload rating -150~200 amperes peak
- Ideal for printed circuit board
- Reliable low cost construction utilizing molded plastic technique
- Plastic material has UL flammability classification 94V-0
- Mounting position: Any
- Mounting torque: 5 In.lb. Max
- Weight: 0.25ounces ,7.0grams

### MAXIMUM RATINGS AND ELECTRICAL CHARACTERISTICS

Rating at 25°C ambient temperature unless otherwise specified.

Single phase, half wave ,60Hz, resistive or inductive load.

For capacitive load, derate current by 20%

### MAXIMUM RATINGS AND ELECTRICAL CHARACTERISTICS

Rating at 25°C ambient temperature unless otherwise specified.

Single phase, half wave ,60Hz, resistive or inductive load.

For capacitive load, derate current by 20%

CHARACTERISTICS	SYMBOL	KBU	KBU	KBU	KBU	KBU	KBU	KBU	UNIT
		4005	401	402	404	406	408	410	
		6005	601	602	604	606	608	610	
		8005	801	802	804	806	808	810	
Maximum Recurrent Peak Reverse Voltage	V <sub>RRM</sub>	50	100	200	400	600	800	1000	V
Maximum RMS Bridge Input Voltage	V <sub>RMS</sub>	35	70	140	280	420	560	700	V
Maximum DC Blocking Voltage	V <sub>DC</sub>	50	100	200	400	600	800	1000	V
Maximum Average Forward Rectified Output Current at T <sub>c</sub> =100°C	I <sub>(AV)</sub>	KBU4	4.0	KBU6	6.0		KBU8	8.0	A
TA=50°C/40°C/45°C			4.0		6.0			6.0	A
Peak Forward Surge Current 8.3ms Single Half Sine-Wave Super Imposed on Rated Load (JEDEC Method)	I <sub>FSM</sub>	KBU4	150	KBU6	170		KBU8	200	A
Maximum Instantaneous Forward Voltage Drop Per Element at 2.0A/3.0A/4.0A	V <sub>F</sub>		1.0		1.0			1.0	V
Maximum Reverse Leakage at Rated DC Blocking Voltage Per Element	I <sub>R</sub>	KBU4	10	KBU6	10		KBU8	10	μA
TA=100°C			100		200			300	mA
Operating Temperature Range	T <sub>J</sub>	-40 to +150							°C
Storage Temperature Range	T <sub>STG</sub>	-40 to +150							°C

# KBU 4 / 6 / 8

## BRIDGE RECTIFIERS

### Characteristic Curves ( $T_A=25^\circ\text{C}$ unless otherwise noted)

